



*Delivery program*

*Rotary screens for textile printing,  
engraving chemicals, endrings*

*Stork Prints*



# NovaScreen®

## Delivery Program Rotary Screens Textile Printing\*\*

Types		Specifications			1280	1620	1850	1850	2250	2400	2800	2800	3200	1
Repeat	Mesh	Thickness	Open Area	Hole diameter	1410	1750	1980	2080	2380	2650	2940	3050	3500	2
(cm)		(µm)	(%)	(µm)	1398.5	1738.5	1968.5		2368.5	2518.5	2918.5	2970	3418.5	3
64	135	105	24	92	*10	*10	*10							
64	135ED	120	22	88	10	10	10	10	*10	10	10	10	10	
64	165	100	21	71	*10	*10	*10							
64	165ED	115	19	67	10	10	10	10	*10	10	10	10	10	
64	195	100	18	55	*10	*10	*10							
64	195ED	115	16	52	10	10	10	10	*5	5	5	5	5	
68.8	135ED	120	22	88	*10	*10	10	*10	*10	*10	*10	*10	*10	
68.8	165ED	115	19	67	*10	*10	10	*10	*10	*10	*10	*10	*10	
68.8	195ED	115	16	52	*10	*10	10	*10	*10	*10	*10	*10	*10	
72.5	135ED	120	22	88	*10	*10	*10	*10	*10	*10	*10	*10	*10	
81.9	135ED	120	22	88	*10	10	10	*10	*10	*10	*10	*10	*10	
81.9	165ED	115	19	67	*10	10	10	*10	*10	*10	*10	*10	*10	
81.9	195ED	115	16	52	*10	10	10	*10	*10	*10	*10	10	10	
91.4	135ED	120	22	88	*10	10	10	10	*10	*10	10	10	10	
91.4	165ED	115	19	67	*10	10	10	10	*10	*10	10	10	10	
91.4	195ED	115	16	52	*10	10	10	10	*10	*10	*10	10	10	
92.3	165ED	115	19	67	*10	*10	*10	*10	*10	*10	*10	*10	*10	
101.8	135ED	120	22	88	*10	*10	*10	*10	*10	*10	*10	*10	*10	
101.8	165ED	115	19	67	*10	*10	*10	*10	*10	*10	*10	*10	*10	

Standard packing unit

3 ::

\* Delivery time on request  
 \*\* All other types on request

1: Printing width (mm)  
 2: Screen length (mm)  
 3: Cutting length (mm)

ED = Extra thickness

# PentaScreen®

Delivery Program Rotary Screens Textile Printing\*\*

Types		Specifications			1280	1620	1850	1850	2250	2400	2800	2800	3200	1
Repeat	Mesh	Thickness	Open Area	Hole diameter	1410	1750	1980	2080	2380	2650	2940	3050	3500	2
(cm)		(µm)	(%)	(µm)	1398.5	1738.5	1968.5		2368.5	2518.5	2918.5	2970	3418.5	3
57.4	105	105	15	94	*5	*5	*5							
57.4	125	100	15	79	*5	*5	*5							
60.9	125	100	15	79	*10	*10	*10							
64	105	105	15	94	20	20	20	20	*10	10	*10	10	10	
64	125	100	15	79	20	20	20	20	*10	10	10	10	10	
64	125V	100	15	79	20	20	20	20	*10	*10	*10	*10	*10	
64	155	100	13	60	10	10	10	10	*10	10	10	10	10	
64	155DLH	105	7	44	*5	5	5	*5	*5	*5	*5	*5	*5	
64	185	90	11	47	*10	*10	*10	*10	*10	*10	*10	*10	*10	
66.8	125	100	15	79	*20	*20	*20	*20	*10	*10	*10	*10	*10	
68.8	125	100	15	79	*20	*20	*20	*20	*10	*10	*10	*10	*10	
68.8	155	100	13	60	*10	*10	*10							
68.8	155DLH	105	7	44	*10	*10	*10							
72.5	125	100	15	79	*20	*20	*20	*20	*10	*10	*10	*10	*10	
72.5	155	100	13	60	*10	*10	*10	*10	*10	*10	*10	*10	*10	
80.1	125	100	15	79	*20	*20	*20	*20	*10	*10	*10	*10	*10	
80.1	155	100	13	60	*10	*10	*10	*10	*10	*10	*10	*10	*10	
81.9	105ED	120	15	94	*20	*20	*20	*20	*10	*10	*10	*10	*10	
81.9	125	100	15	79	*20	20	20	20	*10	10	10	10	10	
81.9	155	100	13	60	*10	10	10	10	*10	10	*10	10	10	
81.9	155DLH	105	7	44	*10	*10	*10							
91.4	105ED	120	15	94	*10	*10	*10	*10	*10	*10	*10	*10	*10	
91.4	125	100	15	79	10	10	10	*10	*10	10	10	10	10	
91.4	155	100	13	60	*10	10	10	*10	*10	10	10	10	10	
91.4	155DLH	105	7	44	*10	*10	*10							
92.3	125	100	15	79	*10	*10	*10	*10	*10	*10	*10	*10	*10	
101.8	125	100	15	79	*10	10	10	10	*10	10	*10	*10	*10	
101.8	155	100	13	60	*10	*10	*10	*10	*10	*10	*10	*10	*10	
106.7	105ED	120	15	94	*10	*10	*10	*10	*10	*10	*10			
106.7	125	100	15	79	*10	*10	*10	*10	*10	*10	*10			
114	105ED	120	15	94	*10	*10	*10							
116.8	105ED	120	15	94	*10	*10	*10	*10	*10	*10				
116.8	125	100	15	79	*10	*10	*10	*10	*10	*10				
120	125	100	15	79	*10	*10	*10							

Standard packing unit

\* Delivery time on request

\*\* All other types on request

1: Printing width (mm)

2: Screen length (mm)

3: Cutting length (mm)

ED = Extra thickness

DLH = Small open area, suitable for transferprint

125V = Same specifications as 125 mesh, especially suitable for geometric designs (horizontal lines)

# StandardScreen

Delivery Program Rotary Screens Textile Printing\*\*

Types		Specifications			1280	1620	1850	1850	2250	2400	2800	2800	3200	1
Repeat	Mesh	Thickness	Open Area	Hole diameter	1410	1750	1980	2080	2380	2650	2940	3050	3500	2
(cm)		(µm)	(%)	(µm)	1398.5	1738.5	1968.5		2368.5		2918.5	2970	3418.5	3
64	40	118	23	318	10	10	10	10	10	10	10	10	5	
64	60	100	14	161	20	20	20	20	10	10	10	10	10	
64	70	100	13	131	*20	*20	*20	*20	*10	*10	*10	*10	*10	
64	80	85	11	105	*20	*20	*20	*20	*10	*10	*10	*10	*10	
64	80ED	95	10	101	20	20	20	20	*10	10	10	10	10	
64	100	95	8	74	20	20	20	20	*10	10	*10	10	10	
66.8	80ED	95	10	101	*20	*20	*20	*20	*10	*10				
68.8	80ED	95	10	101	*20	*20	*20	*20	*10	*10				
68.8	100	95	8	74	*20	*20	*20	*20	*10	*10	*10	*10	*10	
72.5	60	100	14	161	*20	*20	*20	*20	*10	*10	*10	*10	*10	
72.5	80ED	95	10	101	*20	*20	*20	*20	*10	*10	*10	*10	*10	
80.1	80ED	95	10	101	*20	*20	*20	*20	*10	*10	*10	*10	*10	
81.9	40	118	23	318	*20	*20	*20	*20	*10	*10	*10	*10	*10	
81.9	60	100	14	161	*20	*20	*20	*20	*10	*10	*10	*10	*10	
81.9	70	100	13	131	*20	*20	*20	*20	*10	*10	*10	*10	*10	
81.9	80ED	95	10	101	*20	20	20	*20	*10	10	10	10	10	
81.9	100	95	8	74	*20	*20	*20	*20	*10	*10	*10	*10	*10	
91.4	40	118	23	318	*10	*10	*10	*10	*10	*10	*10	*10	*10	
91.4	60	100	14	161	*10	*10	*10	*10	*10	*10	*10	*10	*10	
91.4	70	100	13	131	*10	*10	*10	*10	*10	*10	*10	*10	*10	
91.4	80ED	95	10	101	10	10	10	*10	*10	10	10	10	10	
91.4	100	95	8	74	*10	*10	*10	*10	*10	*10	*10	*10	*10	
101.8	40	118	23	318	*10	*10	*10							
101.8	60	100	14	161	*10	*10	*10	*10	*10	*10	*10	*10	*10	
101.8	80ED	95	10	101	*10	10	10	*10	*10	*10	*10	*10	*10	
101.8	100	95	8	74	*10	*10	*10							
168	60	100	14	161	*10	*10	*10							
168	70	100	13	131	*10	*10	*10							
182	70	100	13	131	*10	*10	*10							

Standard packing unit

\* Delivery time on request  
 \*\* All other types on request

1: Printing width (mm)  
 2: Screen length (mm)  
 3: Cutting length (mm)

ED = Extra thickness

# SpecialScreen®

## Technical specifications

	Standard packing unit	Types repeat (cm)	Mesh holes/inch	Thickness (µm)	Open area(%)	Hole diameter (µm)	Wet paste volume (cm <sup>3</sup> /m <sup>2</sup> )
SP	1	64	14	175	66	1475	115
	1	64	25	150	50	720	75
	5	64	30	120	60	655	72
	5	64	40	120	50	550	60
	1	64	40	150	38	450	57
	5	64	70	120	35	250	42
	1	64	80	150	25	160	38
	1	64	100	150	20	115	30
	1	64	125	150	20	94	30
	5	64	130	120	33	111	40
	5	64	160	120	27	80	32
	5	64	190	120	24	64	29
	5	64	250	100	16	40	16
	5	64	250	80	7	26	6

### SP

Large open area and relatively large number of holes make the SP particularly suitable for applying decorative, patterned paste coatings.

6

	Standard packing unit	Types repeat (cm)	Mesh holes/inch	Thickness (µm)	Open area(%)	Hole diameter (µm)	Wet paste volume (cm <sup>3</sup> /m <sup>2</sup> )
HD	1	64	40	160	17	275	27
	1	64	60	160	10	135	16
	1	64	70	160	7	95	11

### HD

As for LR, but greater wall thickness allows use for heavier applications and large substrates widths.



250SP: raster 60 l/cm



25SP: - particles ± 200 µm  
- no blocking

	Standard packing unit	Types repeat (cm)	Mesh holes/inch	Thickness (µm)	Open area(%)	Hole diameter (µm)	Wet paste volume (cm <sup>3</sup> /m <sup>2</sup> )
LR	5	64	20	125	12	377	15
	5	64	40	125	20	300	25
	5	64	60	125	14.5	165	18
	5	64	70	125	12.5	130	16
	5	64	125	120	12.5	70	15
	5	64	125	115	23	97	26

### LR

Patterned coatings in closed layers. Lighter coatings – artificial leather, backlit material, wallcovering and flooring.

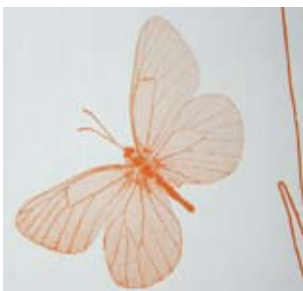

New 125LR: compact PVC and half tones



New 80CH: 3-D high embossing effect

	Standard packing unit	Types repeat (cm)	Mesh holes/inch	Thickness (µm)	Open area(%)	Hole diameter (µm)	Wet paste volume (cm <sup>3</sup> /m <sup>2</sup> )
CH	1	64	40	200	22	300	44
	1	64	40	200	40	400	80
	1	64	50	165	41	325	68
	1	64	50	200	12	175	24
	1	64	50	200	20	230	40
	1	64	80	200	25	160	50
	1	64	125	200	25	105	50
	1	91.4	40	175	22	300	39
	1	91.4	40	200	22	300	44
	1	91.4	60	150	43	278	65
	1	91.4	60	200	11	145	22
	1	91.4	60	300	10	135	30
	1	91.4	80	150	25	160	38
	1	91.4	80	200	25	160	50
	1	91.4	125	150	20	94	30
	1	91.4	125	200	25	105	50

### CH

As for HX. Very stable screen wall, but usually less thick than HX. Suitable for medium-heavy applications.

# SpecialScreen®

## Technical specifications

	Standard packing unit	Types repeat (cm)	Mesh holes/inch	Thickness (µm)	Open area(%)	Hole diameter (µm)	Wet paste volume (cm <sup>3</sup> /m <sup>2</sup> )
HX	1	64	14	450	40	1140	180
	1	64	25	300	30	555	90
	1	64	30	300	40	536	120
	1	64	40	210	25	320	53
	1	64	40	300	30	350	90
	1	64	40	350	12	220	42
	1	64	40	400	20	285	80
	1	91.4	14	450	40	1140	180
	1	91.4	25	300	30	555	90
	1	91.4	25	300	40	643	120
	1	91.4	25	450	12	355	54
	1	91.4	40	300	15	245	45
	1	91.4	40	300	22	300	66
	1	91.4	40	300	30	350	90
	1	91.4	40	350	12	220	42

### HX

Heavy coating; stable and unstable foams; PVC foams on wallcovering, flooring and back coatings. Aluminium layers for sun protection, ironing board covers and protective clothing. Coating of vertical blinds.

	Standard packing unit	Types repeat (cm)	Holes/cm <sup>2</sup>	Thickness (µm)	Open area(%)	Hole diameter (µm)	Wet paste volume (cm <sup>3</sup> /m <sup>2</sup> )
CP	1	64	23	175	12	815	21
	1	64	30	200	13	745	26
	1	64	30	230	7	545	16
	1	64	40	220	10	565	23
	1	64	40	260	8	505	20
	1	64	52	195	12	540	24
	1	64	66	175	7.5	375	13
	1	64	76	160	12	450	19
	1	64	100	200	9.6	350	19
	1	64	120	175	5.9	250	10
	1	64	130	200	7.5	240	12
	1	64	140	200	13.5	350	27
	1	64	160	250	22.1	420	55
	1	64	180	200	17.3	350	35
	1	64	190	175	9.3	250	16
	1	64	200	180	6.3	200	11
1	64	250	215	9.5	220	16	

### CP

As for CC, but with random dot pattern – making CP especially suitable for applying dot coatings to interlinings. Other types can be ordered without additional tooling costs.

7 ::

	Standard packing unit	Types repeat (cm)	Mesh holes/inch	Thickness (µm)	Open area(%)	Hole diameter (µm)	Wet paste volume (cm <sup>3</sup> /m <sup>2</sup> )
CC	1	64	11.2	215	11	790	24
	1	64	11.2	215	17.5	1000	38
	1	64	14	175	13.5	700	24
	1	64	14	215	11	625	24
	1	64	17	175	15	600	26
	1	64	17	215	11.5	530	25
	1	64	23	215	13.5	425	29
	1	64	25	175	18	450	32
	1	64	25	200	9	320	18
	1	64	25	200	14	400	28
	1	64	25	215	12.5	375	27
	1	64	30	215	11.5	300	25

### CC

Dot coating, strengthening textile wovens and nonwovens, anti-slip dots, glue dots to strengthen automotive upholstery, glue for laminate production.

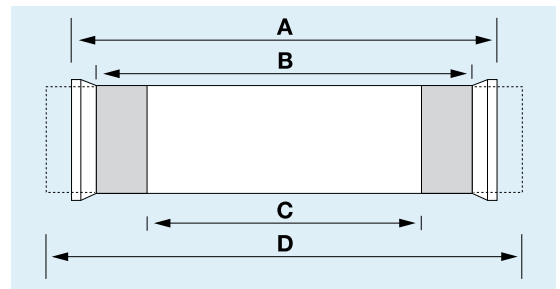

Possible screen lengths (mm): 1410, 1750, 1980, 2650, 3050, 3500, 3800 (other types or specifications available to special order).

- A: machine width
- B: cutting length
- C: application width
- D: screen length

# EffectScreen®

## Delivery Program Rotary Screens Textile Printing

Specifications					1280	1620	1850	1850	2250	2400	2800	2800	3200	1
Types	Mesh	Thickness (µm)	Open Area (%)	Hole diameter (µm)	1410	1750	1980	2080	2380	2650	2940	3050	3500	2
Types (cm)					1398.5	1738.5	1968.5		2368.5	2518.5	2918.5	2970	3418.5	3
64	30	150	28	470	*1	1	1	*1	*1	*1	*1	*1	*1	*1
81.9	30	150	28	470	*1	*1	*1	*1	*1	*1	*1	*1	*1	*1
91.4	30	150	28	470	*1	*1	*1	*1	*1	*1	*1	*1	*1	*1
Standard packing unit														

\* Delivery time on request

1: Printing width (mm)

2: Screen length (mm)

3: Cutting length (mm)

## Unpacking directions for rotary screens

8

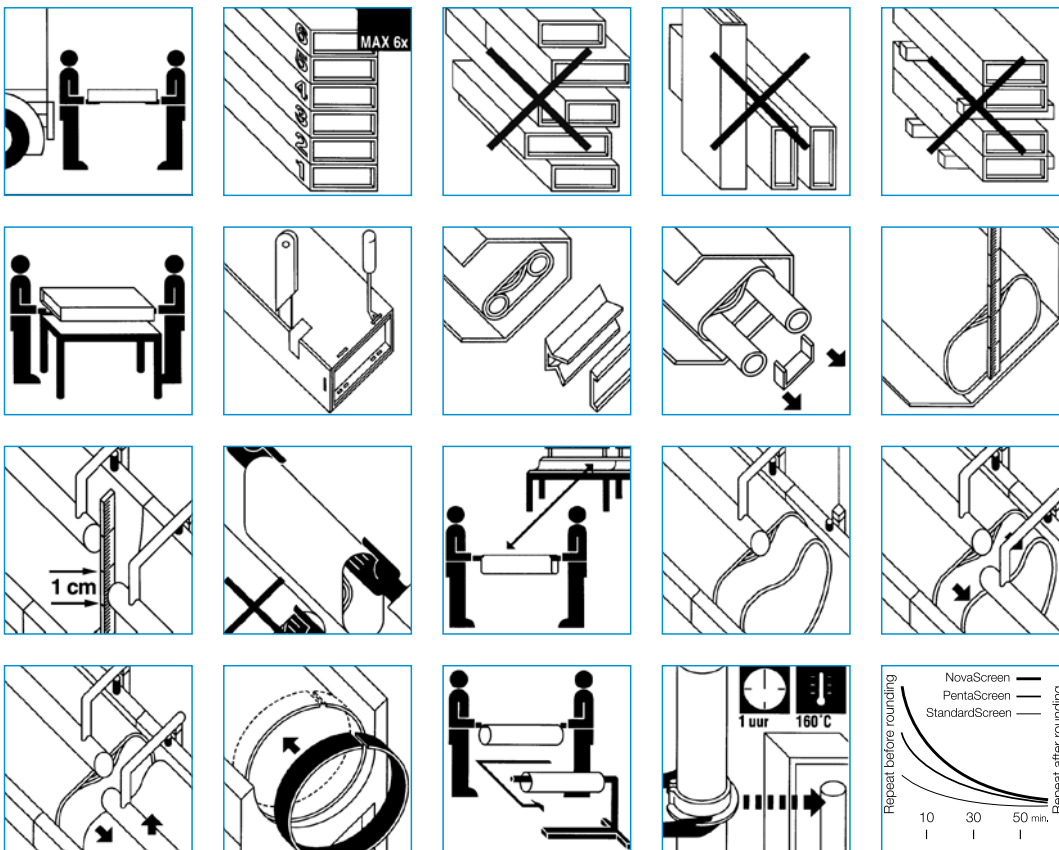

Rounding problems may occur with screens that have been stored for more than two years while still in kidney-shaped packaging





## Delivery Program - Film Products

Product	Description	Packaging
<b>DRAWING FOIL AND INKS</b>		
SCR 54	Water soluble covering paint; red	0.5 kg
SCR 56	Water insoluble covering paint; red	0.5 kg
<b>Daylight film</b>		
SCR 210	Daylight silver film - pos/neg	roll
<b>Plotter and darkroom film products</b>		
SCR 10	Orthochromatic darkroom film - pos/neg (61 m x 76.2 cm)	roll
SCR 10-106	Orthochromatic darkroom film - pos/neg (61 m x 106 cm)	roll
SCR 3088	Infra-red film for film plotter (60 m x 76.2 cm)	roll
SCR 3088L	Infra-red film for film plotter (60 m x 106.7 cm)	roll
SCR 3088XL	Infra-red film for film plotter (60 m x 120 cm)	roll
<b>Film chemicals</b>		
SCR 228	Rapid fixer for darkroom and plotter films	10 L
SCR 229	Developer/replenisher for darkroom and plotter films	10 L

## Delivery Program - Rotary Engraving Chemicals

Product	Description	Packaging
<b>DEGREASING</b>		
SCR 35	Liquid degreasing concentrate for rotary screens	25 kg
<b>COATING</b>		
SCR 100	Universal engraving emulsion, yellow - brown	4 x 5 kg
SCR 102	Universal engraving emulsion, green - blue	4 x 5 kg
SCR 110	Universal engraving emulsion, blue - green	4 x 5 kg
SCR 63	Fine detail emulsion, red	4 x 5 kg
SCR 64	Fine detail emulsion, blue - green	4 x 5 kg
SCR 101	Sensitiser for SCR 100/102/110	4 x 0.25 kg
SCR 61	Sensitiser for SCR 63/64	4 x 0.50 kg
SCR 400	Two component lacquer (SCR 400A/400B) for laser exposure (LEX), red	4 x 5 kg
SCR 405	Second coating for SCR 400	5 kg
<b>RETOUCHING</b>		
SCR 52S	One component lacquer for retouching, before or after polymerisation, brown	4 x 0.25 kg
SCR 165	One component lacquer for retouching, before or after polymerisation, red	4 x 0.25 kg
SCR 166	One component lacquer for retouching, before or after polymerisation, green	4 x 0.25 kg
SCR 160	One component instant drying repair lacquer, blue	15 x 0.025 kg
<b>ENDRING GLUEING</b>		
SCR 53/53C	Two component endring adhesive	1,8 kg
SCR 253	One component infra-red endring adhesive	1 kg
<b>AUXILIARY</b>		
SCR 30	Liquid for removing endrings	13 kg
SCR 33	Liquid stripper for photo lacquer before polymerisation	10 kg
SCR 40	Screen cleaner for removing printing paste	20 kg
SCR 42	Thermoplast stripper	10 L
SCR 43	Thermoplast adhesive	4 kg
SCR 43 XS	Thermoplast adhesive extra strong	4 kg
SCR 44	Thermoplast precoat	1 kg
SCR 45	Dustfix	20 L

## Delivery Program - Flatbed Engraving Chemicals

Product	Description	Packaging
<b>GLUEING</b>		
SCR 527	Planocol mesh adhesive	4 x 5 kg
SCR 527C	Planocol hardener	4 x 1 kg
<b>COATING</b>		
SCR 560	Planotex diazo polymer engraving emulsion, blue, incl. Diazo sensitiser for SCR 564	4 x 4.5 kg
SCR 511	Planotex diazo engraving emulsion, blue	4 x 5 kg
SCR 524	Diazo sensitiser for SCR 511	4 x 0.025 kg
SCR 512	Planotex engraving emulsion, blue	4 x 5 kg
SCR 61	Sensitiser (dichromate) for SCR 512	4 x 0.50 kg
SCR 521	Planofin hardening solution for SCR 511, SCR 512 and SCR 560	10 kg
<b>RETOUCHING</b>		
SCR 160	One component instant drying repair lacquer, blue	15 x 0.025 kg
SCR 166	One component lacquer for retouching, before or after polymerisation, green	4 x 0.25 kg
<b>PROTECTIVE LACQUER</b>		
SCR 535	Planodur lacquer for post lacquering and retouching	4 x 1 kg
SCR 535C	Planodur hardener for SCR 535	4 x 0.25 kg
SCR 526	Planosol thinner for SCR 535/SCR 535C	10 L
<b>AUXILIARY</b>		
SCR 33	Liquid stripper for photo lacquer before polymerisation	10 kg
SCR 40	Screen cleaner for removing printing paste	20 kg

11 ::

## Delivery Program - Endrings

NT-Type (Normal type)	Repeat (cm)	LL-Type (Longlip type)	Repeat (cm)
RD0520	51.8	RD064LL	64.0
RD0540	53.7	RD091LL	91.4
RD0610	60.9		
RD0640	64.0		
RD0670	66.8		
RD0690	68.8		
RD0730	72.5		
RD0820	81.9		
RD0910	91.4		
RD1020	101.8		
RD1030	103.3		

## Stork Prints

The Stork Prints Group is the leading supplier of printing consumable concepts for the textile and graphic markets as well as 2-dimensional, high accuracy, metal precision products. The group achieved a turnover of € 200 million in 2007. For more information please visit [www.storkprints.com](http://www.storkprints.com).

*The Netherlands*  
Stork Prints B.V.  
P.O. Box 67  
5830 AB Boxmeer  
The Netherlands  
Tel.: +31 485 59 95 55  
Fax: +31 485 59 95 56  
[info.storkprints@stork.com](mailto:info.storkprints@stork.com)  
[www.storkprints.com](http://www.storkprints.com)

*U.S.A.*  
Stork Prints America Inc.  
P.O. Box 26458  
Charlotte, N.C. 28221  
U.S.A.  
Tel.: +1 704 598 71 71  
Fax: +1 704 596 08 58

*India*  
Stovec Industries Ltd.  
N.I.D.C. Near Lambha Village  
Post: Narol  
Ahmedabad 382 405  
Gujarat State  
India  
Tel.: +91 79 571 04 07  
Fax: +91 79 571 04 06

*Austria*  
Stork Prints Austria GmbH  
Kufsteiner Strasse 4  
A-6336 Langkampfen  
Austria  
Tel.: +43 5372 69 93 0  
Fax: +43 5372 69 93 54

*Mexico*  
Stork Mexico S.A. de C.V.  
P.O. Box 44-227  
03100 Mexico D.F.  
Mexico  
Tel.: +52 55 56 82 32 99  
Fax: +52 55 56 82 44 04

*Indonesia*  
P.T. Stork Prints Indonesia  
Cikarang Industrial Estate  
Jl. Jababeka Raya  
Block C No. 1  
Bekasi 17550-Jawa Barat  
Indonesia  
Tel.: +62 21 893 41 36  
Fax: +62 21 893 41 35

*Poland*  
Stork Prints Polska Sp. z.o.o.  
ul. Brzezna 3  
90-303 Lodz  
Poland  
Tel.: +48 42 6 37 11 28  
Fax: +48 42 6 37 11 34

*Brazil*  
Stork Prints Brasil Ltda.  
Av. Com. Leopoldo Dedini,  
150  
CEP 13.422-210  
Piracicaba (SP)  
Brazil  
Tel.: +55 19 34 37 13 00  
Fax: +55 19 34 37 13 90

*China*  
Stork Textile Systems Wuxi  
Co. Ltd.  
No. 251, Xing Chuang Ba Lu  
Wuxi-Singapore Industrial Park  
Wuxi, Jiangsu 214028  
P.R. China  
Tel.: +86 510 8528 22 25  
Fax: +86 510 8528 22 41

*Turkey*  
Stork Prints Baski Sistemleri  
Tic Ltd Sti  
Kaya Sultan Sok.  
Huseyin Bagdatlioglu Is  
Merkezi  
No: 97 Kat:1 D:2A Kozyatagi  
34742 Istanbul  
Turkey  
Tel: +90 216 464 83 53  
Fax: +90 216 464 83 57

*Pakistan*  
Stork Prints Pakistan (Pvt) Ltd.  
11, Bangalore Town  
Cooperative Housing Society  
Shahrah-e-Faisal  
KARACHI 75350  
Pakistan  
Tel.: +92 21 455 83 34  
Fax: +92 21 455 82 77

*Japan*  
Stork Prints Japan K.K.  
Daimei Building, 7F  
3-20-10, Toyosaki, Kita-Ku  
Osaka-City  
Osaka Pref. 531-0072  
Japan  
Tel.: +81 66 359 88 65  
Fax: +81 66 359 88 73

The data in this brochure was valid at the time of publishing, and is subject to change without notice. Stork Prints reserves the right to modify its products at any time without further obligation.